

AT ALL EPDM LINED BUILT-IN GUTTERS AT THE BASE OF ALL METAL ROOF AREAS (APPROX. 75 LIN. FT.) CLEAN MEMBRANE, INSTALL SPOT REPAIRS AS REQUIRED AND INSTALL A TWO COAT URETHANE COATING ON BOTTOM AND SIDES OF GUTTER

A LINE ITEM ON THE BID FORM WILL ADDRESS AN ADD ALTERNATE PRICE TO REMOVE THE EXISTING GUTTER LINING AND INSTALL NEW FULLY ADHERED UN-REINFORCED EPDM GUTTER LINER

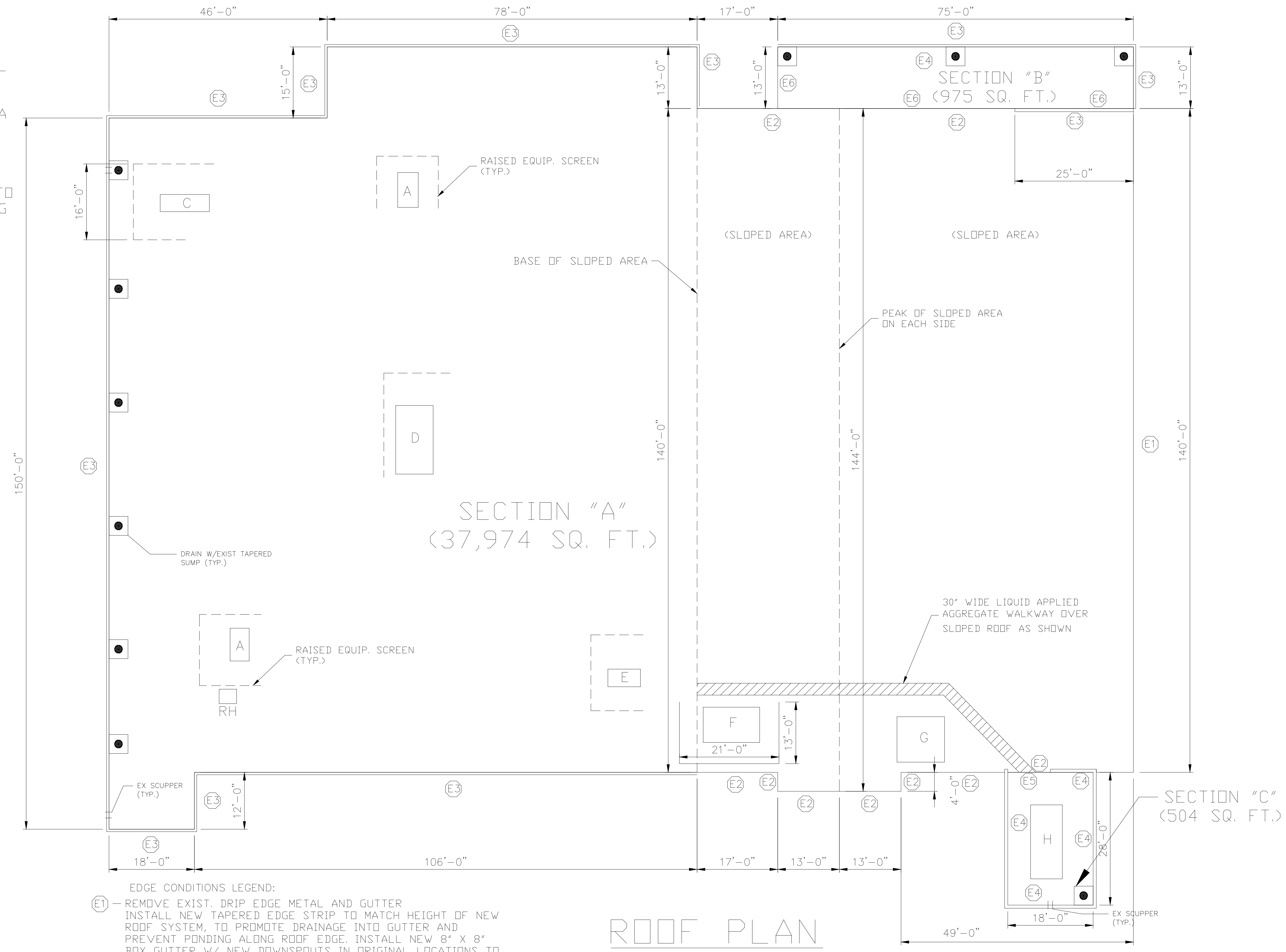

PENETRATIONS LIST:

- CURBS**
 A - 4'X7' RTU
 B - 3'X9'6" KITCHEN EXHAUST CURB WITH DUCT
 C - 3'X6'6" KITCHEN EXHAUST CURB WITH DUCT SUPPORTED BY (2) 3' LONG ESC'S
 D - 7'X10' RTU
 E - CONDENSER ON (2) 6'6" LONG ESC'S
 F - CHILLER UNIT ON (2) 13' LONG ESC'S
 G - 6'6"X6'6" RTV
 H - 6'X15'6" RTU

ROOF HATCH - 33"X39"

PIPES

- 1" - 13
 2" - 3
 3" - 3
 4" - 2
 5" - 4

VENT STACKS

- 8" - 3
 10" - 3

ROUND PITCH BOXES

- 8" - 1
 14" - 1
 16" ROUND PITCH BOX - 31 (VIEW SCREEN SUPPORTS)

- CONDENSER ON (2) 2' LONG ESC - 1
 CONDENSER ON (1) 2'X2' CURB - 1
 CONDENSER ON (2) 4' LONG WOOD SUPPORTS - 1 (REPLACE WOOD W/ P.T. LUMBER AND SET ON WALK PADS)
 2'6"X3'6" RTV - 1
 4'6"X4'6" - 1
 2'6"X2'6" RTV - 1
 1'X1' VENT STACK - 1
 2'X2' KITCHEN EXHAUST FAN - 4
 2'X2' ABANDONED CURB - 2 (REMOVE CURB, CLOSE OPENING IN DECK, INFILL INSULATION TO MATCH HEIGHT OF EXISTING ROOF AND ROOF OVER AREA)
 4'X4' SATELLITE DISH PAD - 1 (SET ON WALK PAD)
 SATELLITE ON 2'X2' CURB - 1

EDGE CONDITIONS LEGEND:

- (E1) - REMOVE EXIST. DRIP EDGE METAL AND GUTTER. INSTALL NEW TAPERED EDGE STRIP TO MATCH HEIGHT OF NEW ROOF SYSTEM, TO PROMOTE DRAINAGE INTO GUTTER AND PREVENT PONDING ALONG ROOF EDGE. INSTALL NEW 8" X 8" BOX GUTTER W/ NEW DOWNSPOUTS IN ORIGINAL LOCATIONS TO MATCH EXISTING CONFIGURATION (SEE DET. 0001)
- (E2) - GRAVEL STOP EDGE METAL, REMOVE EXISTING EDGE METAL, INSTALL NEW GRAVEL STOP EDGE METAL W/ FULLY ADHERED FLASHING (SEE DET. 0002)
- (E3) - 3" (H) TO 4'-11" (HXVARIES) X 0'-11" TO 1'-1" (WXVARIES) PARAPET WALL. REMOVE EXISTING METAL COPING AND WALL FLASHINGS. INSTALL FULLY ADHERED WALL FLASHING OVER EXIST. TOP PLATE AND DOWN FRONT FACE, INSTALL NEW TWO PIECE METAL FASCIA (SEE DET. 0003)
- (E4) - 8'-0" (H) PARAPET WALL. REMOVE LOW FLASHINGS AND COUNTER FLASHING. REMOVE METAL COPING AT TOP OF WALL. INSTALL 1/2" DENS DECK MECHANICALLY ATTACHED FULL HEIGHT OF WALL. INSTALL FULLY ADHERED NEW WALL FLASHING FULL HEIGHT, OVER TOP OF EXISTING BLOCKING AND ONTO OUTER FACE OF BLOCKING. INSTALL NEW TWO PIECE METAL FASCIA (SEE DET. 0003)
- (E5) - 2'-0" TO 3'-6" (H) WALL. REMOVE LOW FLASHINGS AND COUNTER FLASHING. INSTALL 1/2" DENS DECK MECHANICALLY ATTACHED FULL HEIGHT OF WALL. INSTALL FULLY ADHERED NEW WALL FLASHING FULL HEIGHT, INSTALL TERM BAR AND SEALANT UNDER NEW EDGE METAL NOTED IN EDGE CONDITION E2
- (E6) - 1'-0" (H) WALL FLASHING, REMOVE ALL FLASHINGS FULLY ADHERE NEW WALL FLASHING, INSTALL TERM BAR, SEALANT AND NEW SURFACE MOUNTED COUNTER FLASHING W/ SEALANT JOINT (SEE DET. 0004)

ROOF PLAN

General Notes



DISCLAIMER
 ALL DEAD, DESIGNED ARRANGEMENTS, AND PLANS INDICATED OR REPRESENTED BY THIS DRAWING ARE OWNED BY AND ARE THE PROPERTY OF ROOFINGPROJECTS.COM AND WERE CREATED, EVOLVED AND DEVELOPED FOR USE ON AND IN CONNECTION WITH THE SPECIFIED PROJECT. NONE OF SUCH LOGOS, DESIGNS, ARRANGEMENTS OR MARKS SHALL BE USED BY OR DISCLOSED TO ANY THIRD PARTY WITHOUT THE WRITTEN PERMISSION OF ROOFINGPROJECTS.COM.
 WRITTEN DIMENSIONS ON THIS DRAWING SHALL TAKE PRECEDENCE OVER SCALED DIMENSIONS. CONTRACTOR SHALL VERIFY AND BE RESPONSIBLE FOR ALL DIMENSIONS AND CONDITIONS ON THE JOB AND THIS OFFICE MUST BE NOTIFIED OF ANY VARIATIONS FROM THE DIMENSIONS AND CONDITIONS SHOWN ON THESE DRAWINGS.

No.	Revision/Issue	Date

Firm Name and Address
 RoofingProjects.com
 17 High Street
 Suite 301
 Norwalk, CT
 06851

Project Name and Address
 2026
 Acme #3824
 3428 Simpson Ave
 Ocean City, NJ 08226

Project	Sheet
Date April 2, 2026	1
Scale 3/32" = 1'-0"	